

# \$295,000 - 355 E Thomas Road (unit B206), Phoenix

MLS® #6812455

## \$295,000

2 Bedroom, 2.00 Bathroom, 1,102 sqft  
Residential on 0 Acres

### WINDSOR PLACE, Phoenix, AZ

Located in the heart of Midtown Phoenix, this 2 bedroom, 2 bathroom Windsor Place gem offers unbeatable convenience with nearby bus stops, dining, and shopping options. Inside, the open layout features high ceilings, wood look flooring, and a contemporary kitchen with quartz countertops, stainless steel appliances, and a peninsula perfect for casual meals. The primary bedroom includes a private en-suite bathroom, and the washer and dryer already in the unit are included with the sale for your convenience. Enjoy added peace and privacy with no upstairs neighbors, and unwind on your private balcony or take advantage of community perks like the sparkling pool and beautifully maintained common areas. This is a rare opportunity you don't want to miss!

Built in 1960

### Essential Information

MLS® #	6812455
Price	\$295,000
Bedrooms	2
Bathrooms	2.00
Square Footage	1,102
Acres	0.00
Year Built	1960
Type	Residential
Sub-Type	Apartment

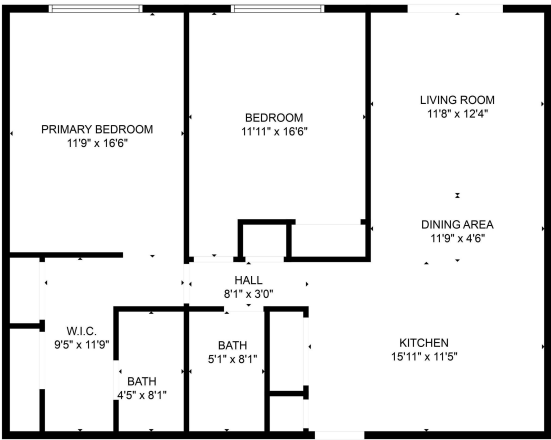

2025 ARMLS

FLOOR PLAN CREATED BY CUBICSCAN APP. MEASUREMENTS DEEMED HIGHLY RELIABLE BUT NOT GUARANTEED.



Style	Contemporary
Status	Active

### Community Information

Address	355 E Thomas Road (unit B206)
Subdivision	WINDSOR PLACE
City	Phoenix
County	Maricopa
State	AZ
Zip Code	85012

### Amenities

Amenities	Gated, Community Pool, Near Bus Stop, Community Laundry
Utilities	APS
Parking Spaces	1
Parking	Assigned
Pool	None

### Interior

Interior Features	High Speed Internet, Breakfast Bar, 9+ Flat Ceilings, No Interior Steps, 3/4 Bath Master Bdrm
Heating	Electric
Cooling	Central Air
Fireplaces	None
# of Stories	2

### Exterior

Exterior Features	Balcony
Windows	Dual Pane
Roof	Built-Up
Construction	Stucco, Painted, Block

### School Information

District	Phoenix Union High School District
Elementary	Encanto School
Middle	Osborn Middle School
High	Central High School

### Listing Details

Listing Office	Nexthome Complete Realty
----------------	--------------------------

Information Deemed Reliable But Not Guaranteed. All information should be verified by the recipient and none is guaranteed as accurate by ARMLS. ARMLS Logo indicates that a property listed by a real estate brokerage other than Launch Real Estate LLC. Copyright 2025 Arizona Regional Multiple Listing Service, Inc. All rights reserved.

Listing information last updated on July 15th, 2025 at 6:31pm MST